



Hall Street, Clerkenwell
£470,000

Victorstone
PROPERTY CONSULTANTS

213 City Road, London, EC1V 1JN

Tel: 0207 858 1588

Email: city@victorstone.co.uk

Web: www.victorstone.co.uk

Victorstone
PROPERTY CONSULTANTS

Located in the heart of CLERKENWELL and within walking distance of OLD STREET, ANGEL and the CITY this bright and spacious 20th floor apartment offers a generous living space, plenty of storage and stunning uninterrupted VIEWS ACROSS LONDON with added benefit of 24 hour Concierge. Angel Underground Station is only a few minutes walk away and is close to City University, Guild Hall School Of Music and Drama, Moorgate and Farringdon.

The entrance hall leads to TWO DOUBLE bedrooms, multiple storage cupboards, a separate bathroom and WC, a bright eat in kitchen and separate lounge, all the rooms offer views across the city. This property would make an ideal BUY TO LET investment, PIED-A-TERRE or a first home.

£470,000



Living room

Laminate wood flooring, TV and Power points, radiator, south facing double glazed window

Kitchen

Range of high and low level cupboards, stainless steel sink with drainer and mixer tap, space for freestanding electric oven with 4 burner gas hob, fridge/freezer, washing machine, ample power points, radiator, laminate wood flooring and easterly aspect double glazed windows.

Bedroom One

Southerly aspect, double glazed windows, radiator, power point and laminate wood flooring

Bedroom Two

Southerly aspect, double glazed windows, radiator, power point and laminate wood flooring

Bathroom

Bath with tiled surround, mixer taps and shower attachment, wall hung mirror, with hot and cold taps, extractor fan and radiator.

W.C

Low level flush WC, extractor fan

Hallway

Laminate wood flooring, radiator, storage cupboards, entry phone and power point.



- Stunning views across London
- Separate Kitchen
- Double Glazing
- Separate WC
- Lots of Storage
- 7 min walk to Angel Station
- City University 2 min walk

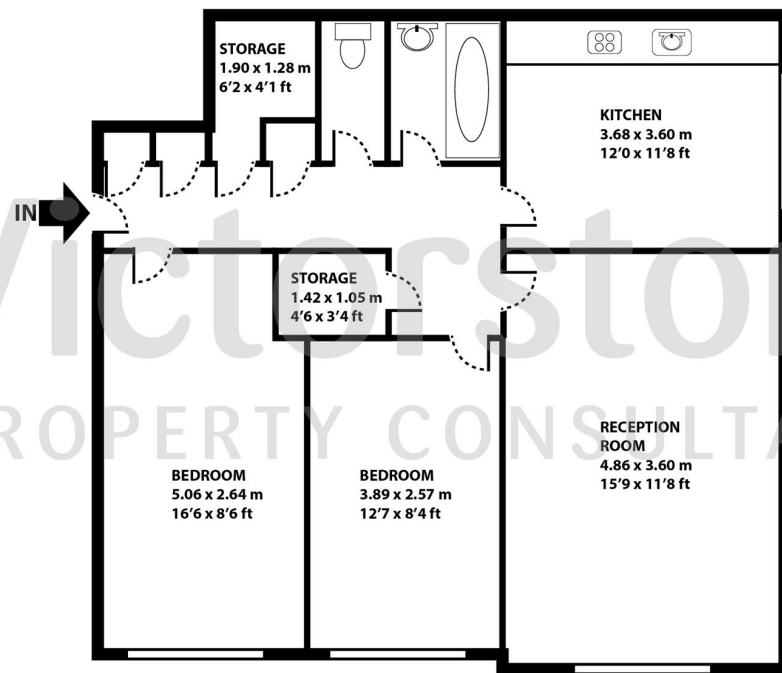

TOTAL: 70 sqm | 753 sqft

ALL MEASUREMENTS ARE APPROXIMATE AND ARE FOR DISPLAY PURPOSES ONLY **NOT TO SCALE**



Important notice: Victorstone, their clients and any joint agents give notice that: These particulars are prepared as a general guide to the property and do not form part of any offer or contract and must not be relied upon as statements or representations of fact. They have not conducted a structural survey and the services, appliances and specific fittings have not been tested. All photographs, measurements, floorplans and distances referred to are given as a guide only. Any and all fixtures and fittings listed in these particulars are deemed removable by the vendor. Any measurements should not be relied upon for the purchase of flooring or any other fixtures or fittings. Ground rent, service charges and any other lease details (where applicable) and council tax are given as a guide only and should be checked and confirmed by your Solicitor prior to exchange of contracts.