



Flat 3 10 Queen's Road, St. Helier Jersey JE2 3GR

Our Ref:Apt540. Qualified. A delightful 2 bedroom apartment on the fringes of St Helier and just 10 minutes walk to the town centre. Beautiful Georgian property tastefully converted into individual apartments taking advantage of the large rooms, high ceilings and big windows flooding each room with light. Set on the first floor of the building the accommodation briefly comprises of entrance hall, leading off to the living area which further leads to the light and bright modern kitchen. A large double bedroom and a slightly smaller second bedroom provides ample space for a young family. The newly refurbished house bathroom compliments this walk-in condition apartment. Must be seen and early viewing recommended. Parking to be discussed. Sole agent. Ideal investment opportunity with current tenants providing circa 4.5% return! Tenancy lease until December 2024.

- 2 Bedroom Apartment
- Investment Opportunity- Tenanted to December 2024
- Close to Town
- Use of dedicated parking space
- Share Transfer; Investment return circa 4.5%
- Sole Agent

Asking Price £385,000

Flat 3 10 Queen's Road, St. Helier, Jersey JE2 3GR

ENTRANCE HALL

LIVING ROOM

14'6x13'2 (4.42mx4.01m)

KITCHEN

10'6x7'10 (3.20mx2.39m)

HOUSE BATHROOM

BEDROOM 1

14'1x10'1 (4.29mx3.07m)

BEDROOM 2

10'1x7'5 (3.07mx2.26m)

SERVICES

Electric heating throughout. Service charge £75 per month.
Share Transfer. Current tenant lease expires Dec 2023.



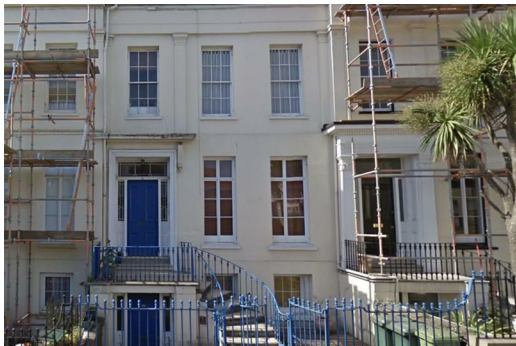

1ST FLOOR

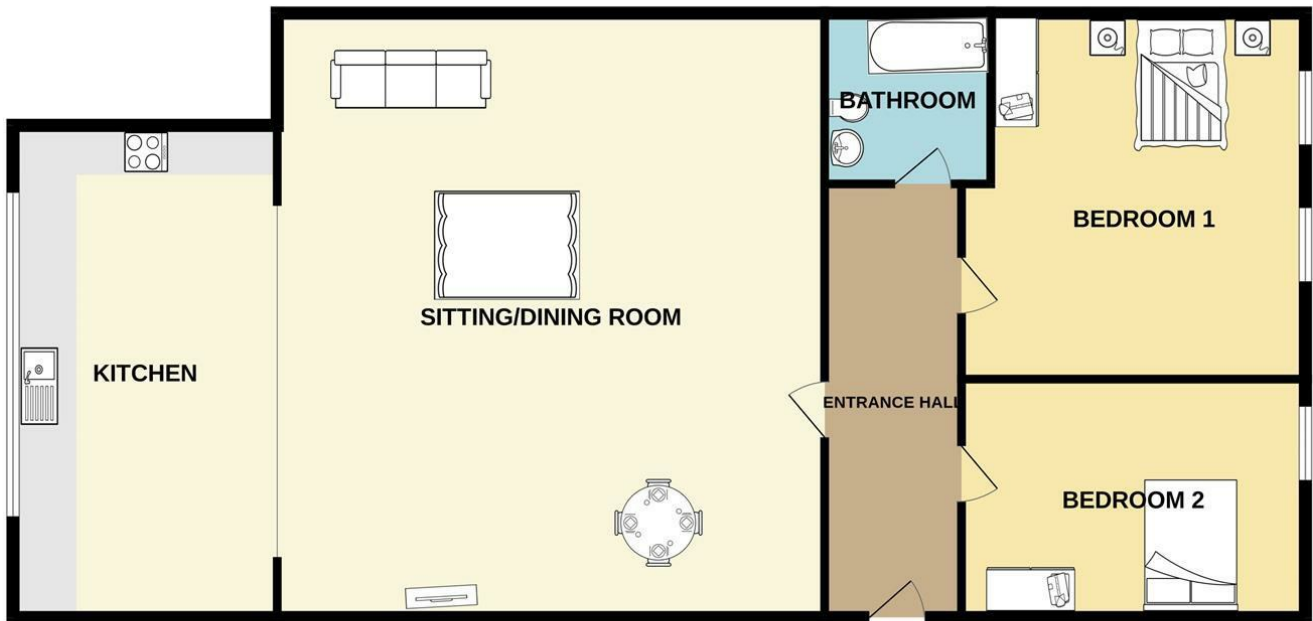

Whilst every attempt has been made to ensure the accuracy of the floorplan contained here, measurements of doors, windows, rooms and any other items are approximate and no responsibility is taken for any error, omission or mis-statement. This plan is for illustrative purposes only and should be used as such by any prospective purchaser. The services, systems and appliances shown have not been tested and no guarantee as to their operability or efficiency can be given.
Made with Metropix ©2023

