



Chiswick Village | Chiswick | W4 3BY

**£1, 500 per month
(Inclusive of Water and Gas)**

A high standard two bedroom third floor flat with lift and entry phone access situated within this popular development in the heart of Chiswick. The property is part furnished and comprises the following; two good size bedrooms, large sitting room with dining area with doors leading to a private balcony, modern fitted kitchen, family bathroom, communal garden and on street permit parking.

Residents are a walking distance to the Chiswick High road, the local restaurants, café shops, local parks and shopping. Gunnersbury Station and Kew Bridge station (District Line and National Rail) is also nearby. Motorists benefit from good access to the M4, South and North Circular Roads. Local schools are Strand on the Green Junior and Infant Schools and Grove Park Primary School.

Available Now.

Tenant fees apply: £180 tenancy handling fee (Inclusive of VAT); £60 referencing fee per adult (Inclusive of VAT). Other fees may apply.

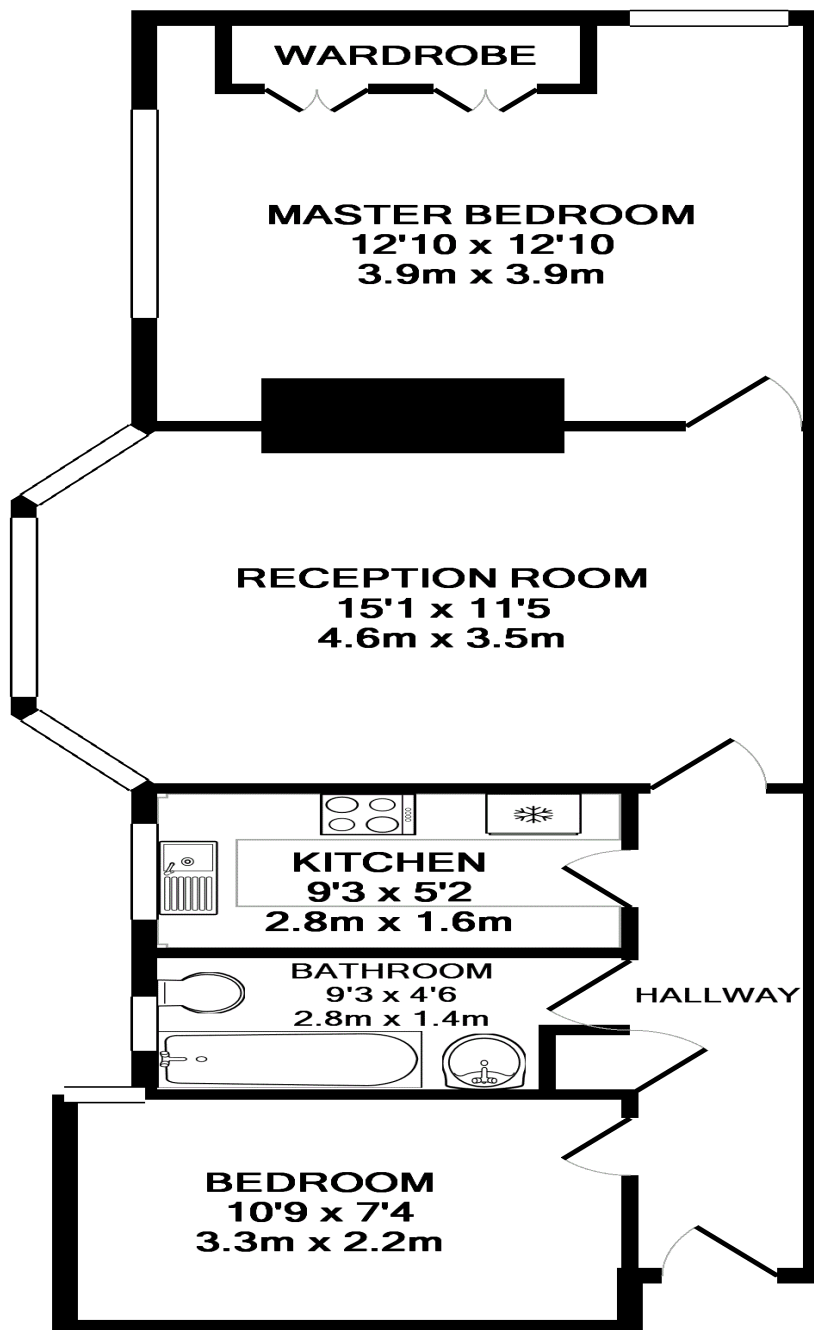

TOTAL APPROX. FLOOR AREA 540 SQ.FT. (50.2 SQ.M.)

Whilst every attempt has been made to ensure the accuracy of the floor plan contained here, measurements of doors, windows, rooms and any other items are approximate and no responsibility is taken for any error, omission, or mis-statement. This plan is for illustrative purposes only and should be used as such by any prospective purchaser. The services, systems and appliances shown have not been tested and no guarantee as to their operability or efficiency can be given
Made with Metropix ©2018

Contact Details

Sales, Lettings & Property
Management

2 Queens Drive,
West Acton,
London,
W3 OHA

www.japanservices.co.uk
properties@japanservices.co.uk
0208 752 0445

