



EXETER CRESCENT
£205,000



ANDREW HILL

6 EXETER CRESCENT

Harrogate, HG3 2TF

A three bedroom town house with two reception rooms, garage and garden, located in a popular residential area close to countryside on the outskirts of the town.





- Modern Town House
- 3 Bedrooms
- Sitting Room

- Dining Room
- Kitchen
- White Bathroom Suite

- Detached Garage
- Popular Location
- Close To Countryside

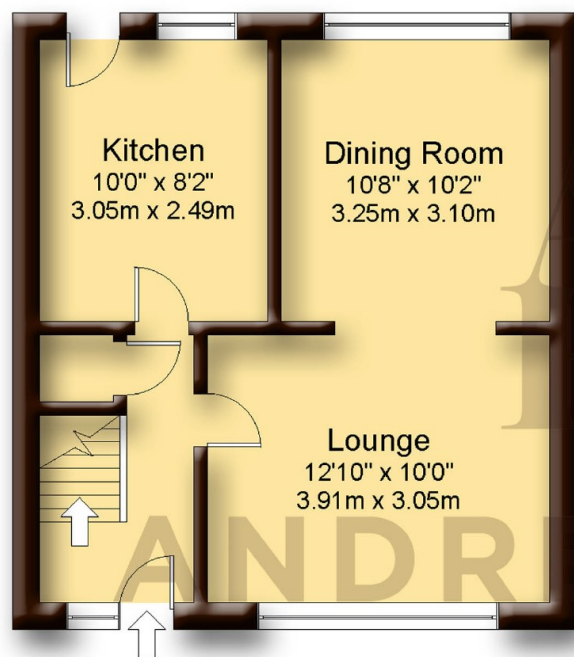

Ground Floor

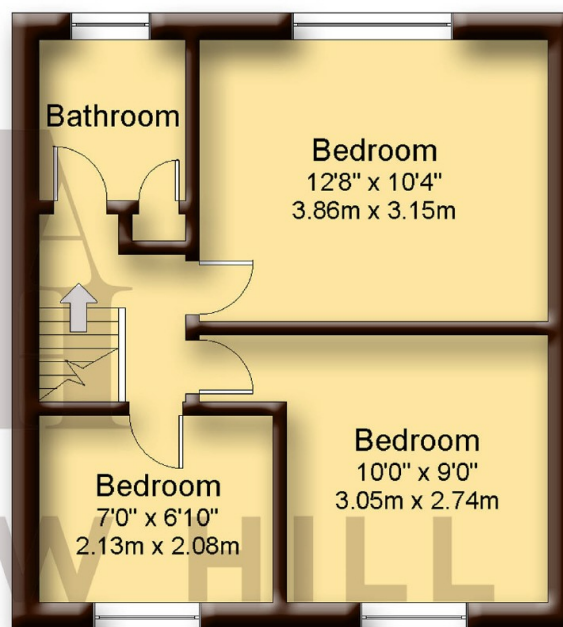

First Floor

Not to Scale. Copyright © Apex Plans.

Services

Mains services connected.
Gas central heating.
Sealed unit double glazing.
Council tax band C.
EPC rating C.
Approx 796 sq ft.

9 Princes Square, Harrogate, HG1 1ND

T: 01423 528 528

E: hello@andrewhill.co

www.andrewhill.co



ANDREW HILL