



STATION ROAD  
**£750,000**



**ANDREW HILL**

# INCHMARLO

Station Road, Cattal, YO26 8DX

A most attractive individually designed & built detached family sized house revealing exceptionally spacious and bespoke accommodation with 4 bedrooms and 4 reception rooms and featuring a lovely garden backing onto fields.

The property boasts an imposing entrance hall with oak staircase & galleried landing. The four reception rooms are complimented by a painted kitchen and utility room.

The master bedroom has a dressing room and en suite bathroom and the other three bedrooms use the modern house bathroom.

There is a massive attic space which could be converted.

Double garage and large driveway.

Inchmarlo occupies an established setting with good sized lawned gardens within the heart of this small yet superbly located village which incorporates a railway station and is conveniently placed for commuting up and down the country.







- Individual Detached
- Bespoke Interior
- Village Location

- 4 Bedrooms
- 4 Reception Rooms
- Massive Loft

- Garden Adjoining Fields
- Fantastic Hall & Landing
- Great Sized Rooms

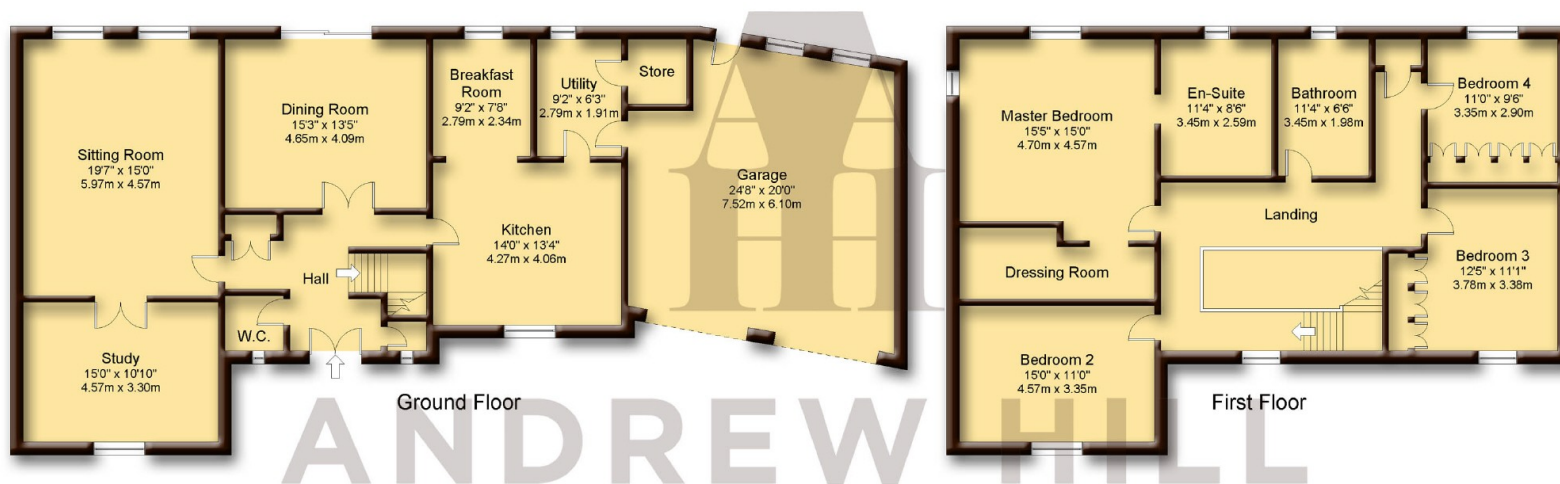

### Services

- Mains electric and water.
- Oil central heating.
- Sealed unit double glazing.
- Council tax band G.
- EPC rating E.
- Approx 2325 sq ft.

Not to Scale. Copyright © Apex Plans.

9 Princes Square, Harrogate, HG1 1ND

T: 01423 528 528

E: hello@andrewhill.co

www.andrewhill.co



**ANDREW HILL**