

Gilbert Court, Willoughby Road, Harpenden

£1,250 PCM

Approximate Gross Internal Area 506 sq ft – 48 sq m

Ground Floor Area 253 sq ft – 24 sq m

First Floor Area 253 sq ft – 24 sq m

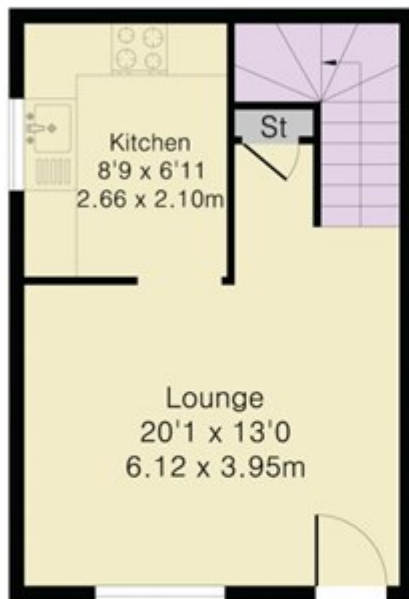

Ground Floor



First Floor



Although Pink Plan Ltd ensures the highest level of accuracy, measurements of doors, windows and rooms are approximate and no responsibility is taken for error, omission or misstatement. These plans are for representation purposes only as defined by RICS code of measuring practice. No guarantee is given on total square footage of the property within this plan. The figure icon is for initial guidance only and should not be relied on as a basis of valuation.

