

# Roundwood Lane, Harpenden

## Guide Price £150,000 Leasehold

---

Approx. 40.7 sq. metres (438.4 sq. feet)

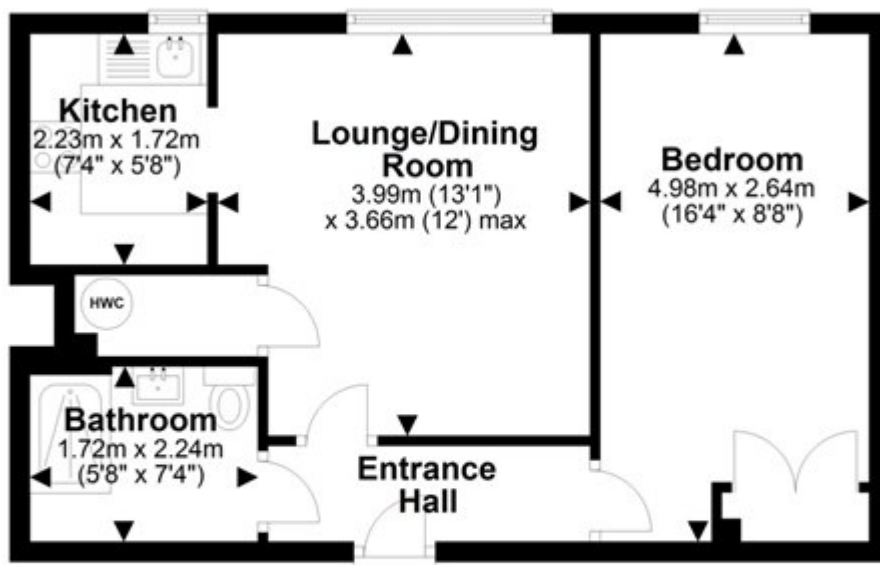

Total area: approx. 40.7 sq. metres (438.4 sq. feet)

Floorplan is not to scale and to be used for layout guidance only, any measurements shown should NOT be relied upon. Floor Area (Sq/m) includes all areas shown on plan except Balconies, Patios, Eaves, Garden and Parking Areas unless otherwise indicated.