

# Hollybush Lane, Harpenden

## £1,400 PCM

---

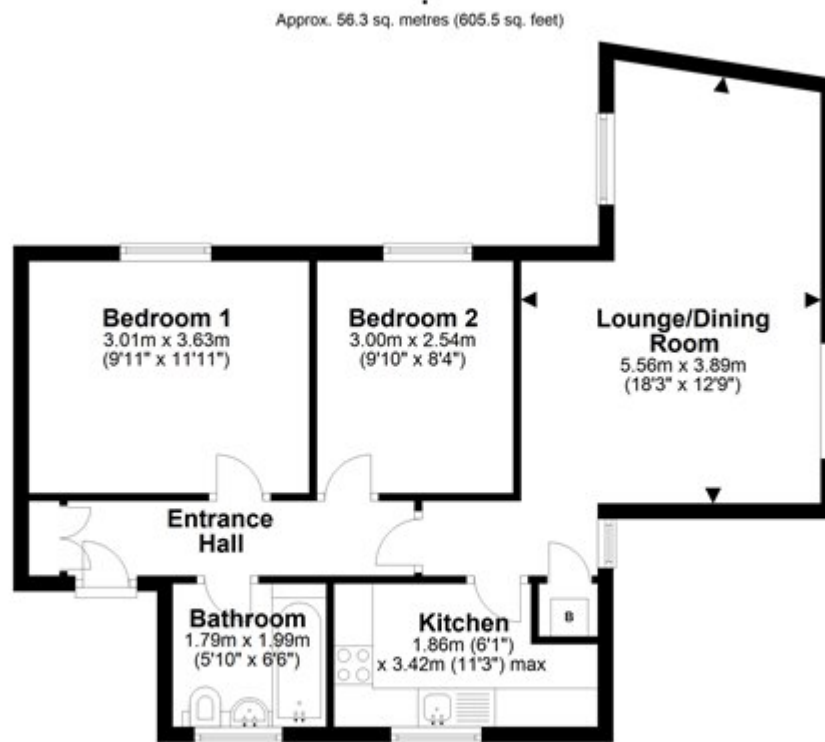

Total area: approx. 56.3 sq. metres (605.5 sq. feet)

Floorplan is not to scale and to be used for layout guidance only, any measurements shown should NOT be relied upon.  
Floor Area (Sq/m) includes all areas shown on plan except Balconies, Patios, Eaves, Garden and Parking Areas unless otherwise indicated.

Plan produced using PlanUp.